

RONALD H. ZIMMERMAN  
REGISTERED LAND SURVEYOR

PLAT OF SURVEY

FOR

WAUKESHA SAVINGS & LOAN

20'

STREET

100.0' TO S. LINE  
WHITE OAK DRIVE

SCALE 1" = 30'

o - INDICATES IRON PIPE,  
FOUND

N

2

24

140.0'

3

23

GVL. DRIVE

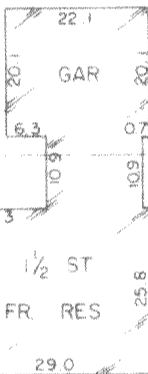

NO  
1014

100.0'

4

22

56.2

140.0'

50.0'

5

21

Lots 2 and 4 in Block 8 of Miramar Subdivision, according to the recorded plat thereof, Walworth County, Wisconsin.

CERTIFICATION

STATE OF WISCONSIN : SS  
COUNTY OF WAUKESHA : SS

I HAVE SURVEYED THE ABOVE DESCRIBED PROPERTY AND THE ABOVE MAP IS A TRUE REPRESENTATION THEREOF AND SHOWS THE SIZE AND LOCATION OF THE PROPERTY, ITS EXTERIOR BOUNDARIES, THE LOCATION AND DIMENSIONS OF ALL VISIBLE STRUCTURES THEREON, FENCES, APPARENT EASEMENTS AND ROADWAYS AND VISIBLE ENCROACHMENTS, IF ANY.

THIS SURVEY IS MADE FOR THE EXCLUSIVE USE OF THE PRESENT OWNERS OF THE PROPERTY, AND ALSO THOSE WHO PURCHASE, MORTGAGE, OR GUARANTEE THE TITLE THERETO WITHIN ONE (1) YEAR FROM DATE HEREOF, AND AS TO THEM I WARRANT THE ACCURACY OF SAID SURVEY AND MAP.

DATE MARCH 20 1975

*Ronald H. Zimmerman*  
RONALD H. ZIMMERMAN S. 868

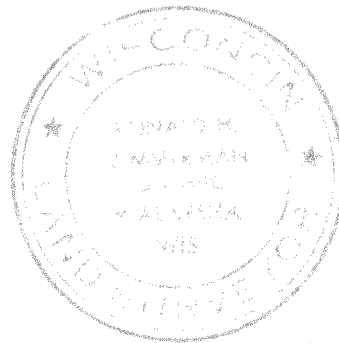

418-252